

**HAYWOOD COUNTY
BOARD OF COMMISSIONERS
WORK SESSION**

January 14, 2014

4:00 p.m.

**Planning Department Conference Room
157 Paragon Parkway
Clyde, NC**

Agenda

- I. Opening Remarks – Chairman Mark Swanger
- II. Former Department of Corrections Facility in Hazelwood
 - a. Dale Burris – Facilities and Maintenance Director – Current Site and Proposed Demolition – ATTACHMENT 1
 - b. Power Point Presentations –
 - i. Haywood Christian Emergency Shelter – ATTACHMENT 2
 - ii. Next Step Ministries – ATTACHMENT 3
 - c. Commissioner Discussion and Direction
- III. Former Haywood County Hospital Facility
 - a. Dale Burris – Facilities and Maintenance Director – Current Site Description
 - b. Commissioner Discussion and Direction
- IV. Adjourn

Attachment

1



1 inch = 25 feet

HAYWOOD COUNTY FORMER NCDOC FACILITY

Haywood County NCDOC Facility

BUILDING	YEAR CONSTRUCTED	SQUARE FOOTAGE	WALL CONSTRUCTION	ROOF CONSTRUCTION	HEATING SYSTEM
#1 ADMIN	1931	1472	MASONRY/VINYL	ASPHLT SHINGLE	NATURAL GAS HP (EM/VEG)
#2 FIRST AID	1931	361	BRICK/MASONRY	FLAT CONCRETE	NATURAL GAS WALL PACK
#3 NURSE BLDG	1931	652	BRICK/MASONRY	FLAT CONCRETE	NATURAL GAS WALL PACK
#4 MAINT. TRAILER	???	744	METAL SIDING	METAL ROOF	NATURAL GAS HEAT PUMP
#5 LAUNDRY	1959	1152	VINYL SIDING	ASPHLT SHINGLE	NATURAL GAS WALL PACK
#6 STORAGE UNIT	???	324	METAL SIDING	METAL ROOF	NONE
#7 DORMITORY	1931	3752	BRICK/MASONRY	ASPHLT RUBBER	NATURAL GAS BOILER #2
#8 DINING HALL	1959	2940	VINYL SIDING	ASPHLT SHINGLE	NATURAL GAS WALL PACK
#9 CHAPEL	1959	640	BRICK/MASONRY	ASPHLT SHINGLE	NATURAL GAS WALL PACK
#10 DORMITORY	1993???	2970	METAL SIDING	RUBBER TPO	NATURAL GAS #2 #4
#11 DORMITORY	1993???	2970	METAL SIDING	RUBBER TPO	NATURAL GAS #2 #4
#12 GUARD HOUSE	???	640	VINYL SIDING	RUBBER TPO	NATURAL GAS #2 #4
#13 STORAGE BLDG	2008	144	METAL SIDING	METAL ROOF	NATURAL GAS WALL PACK
#14 STORAGE BLDG	???	240	METAL SIDING	METAL ROOF	NONE
#15 STORAGE BLDG	???	228	VINYL SIDING	ASPHLT SHINGLE	NONE
PERIMETER AREA IN AND AROUND COMPOUND	1978 UP TO 81	#	WIRE MESH	WITH TWO ROWS	RATCH WIRE

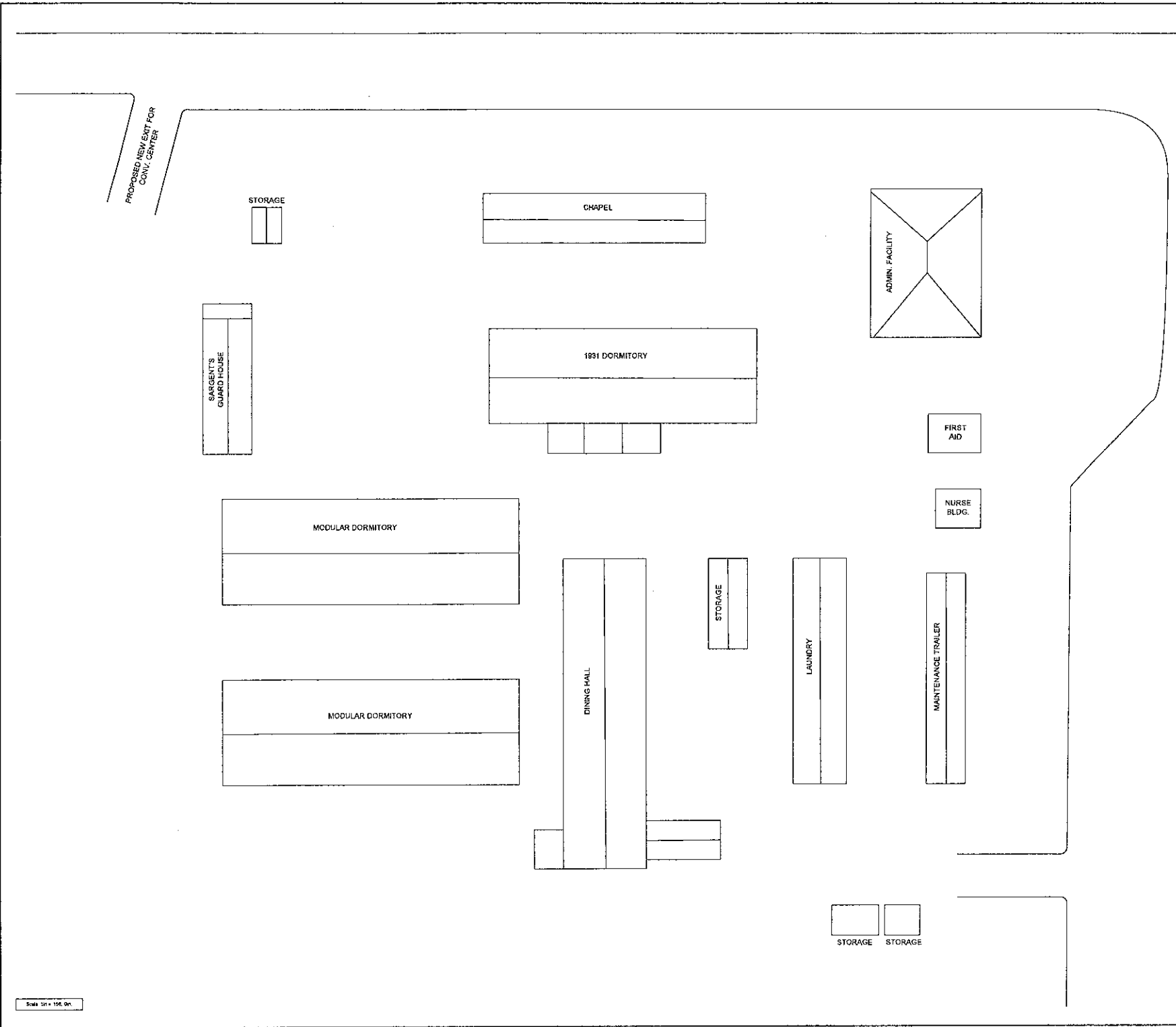

Scale 1/4" = 100' 0"

<p>HAYWOOD COUNTY FACILITIES AND MAINTENANCE DEPARTMENT</p>
<p>HAYWOOD COUNTY FORMER NCDOC FACILITY</p>
<p>12-23-2013 DB</p>
<p>SITE PLAN CS1.0</p>

Scale 1/4" = 10' 0"

PROPOSED NEW EXIT FOR
COMV. CENTER

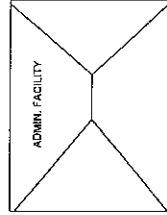
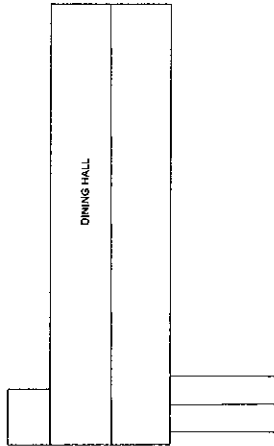
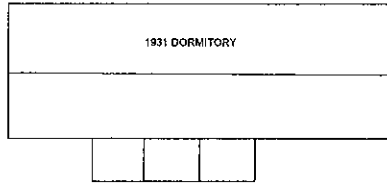
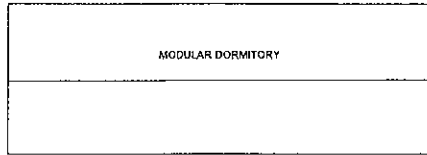
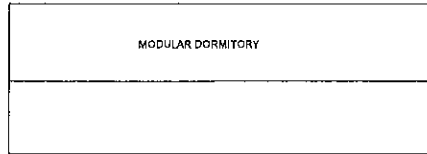

RELOCATED
STORAGE BLDG.

12-23-2013
DB

**SITE PLAN
CS1.1
DEMO**

**HAYWOOD COUNTY
FORMER NCDOC FACILITY**

HAYWOOD COUNTY
FACILITIES AND MAINTENANCE DEPARTMENT

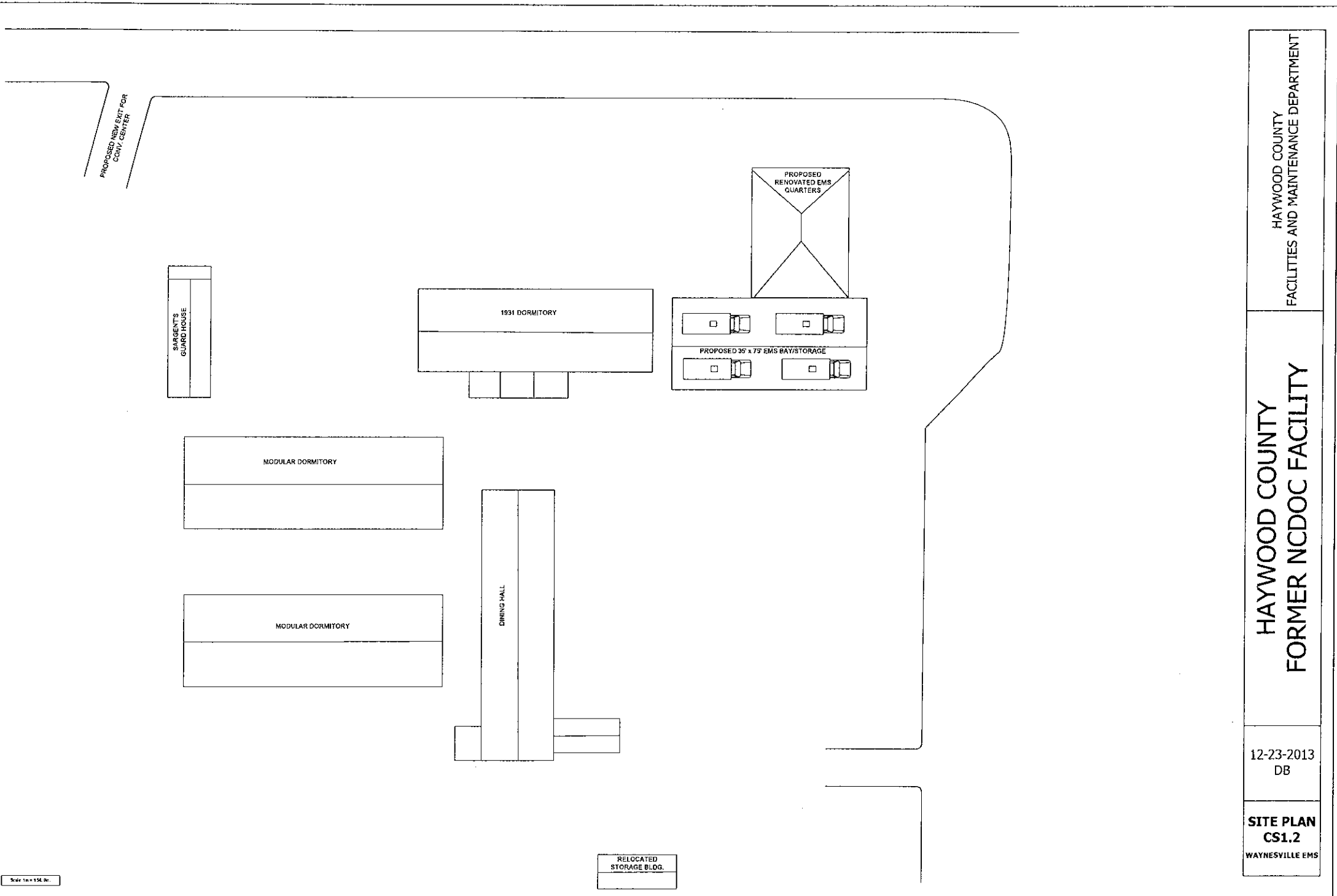

Scale 1/4" = 154.0'

HAYWOOD COUNTY
FACILITIES AND MAINTENANCE DEPARTMENT

HAYWOOD COUNTY
FORMER NCDOC FACILITY

12-23-2013
DB

SITE PLAN
CS1.2
WAYNESVILLE EMS

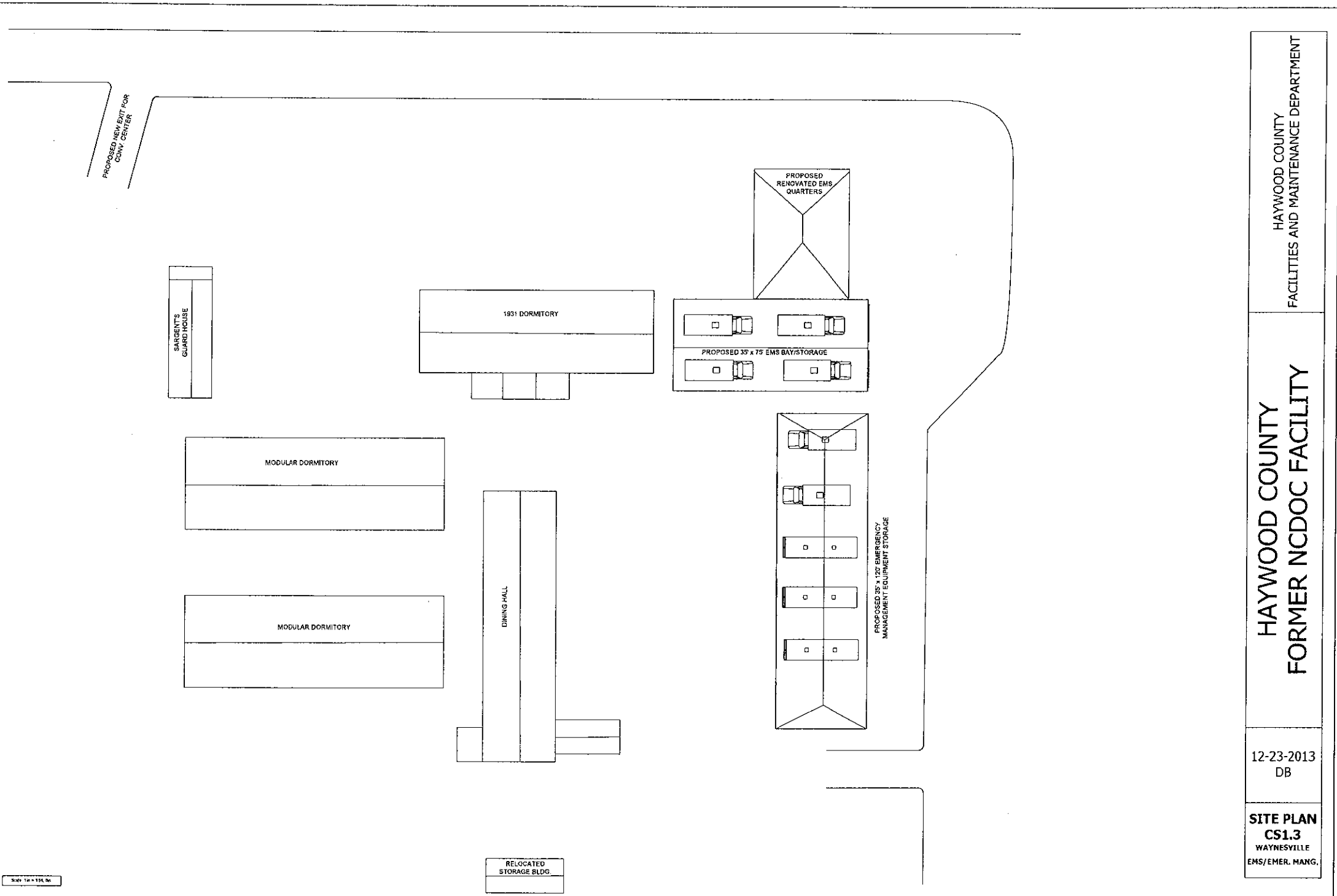

Scale 1/8" = 100' 0"

HAYWOOD COUNTY
FACILITIES AND MAINTENANCE DEPARTMENT

HAYWOOD COUNTY
FORMER NCDOC FACILITY

12-23-2013
DB

SITE PLAN
CS1.3
WAYNESVILLE
EMS/EMER. MANG.

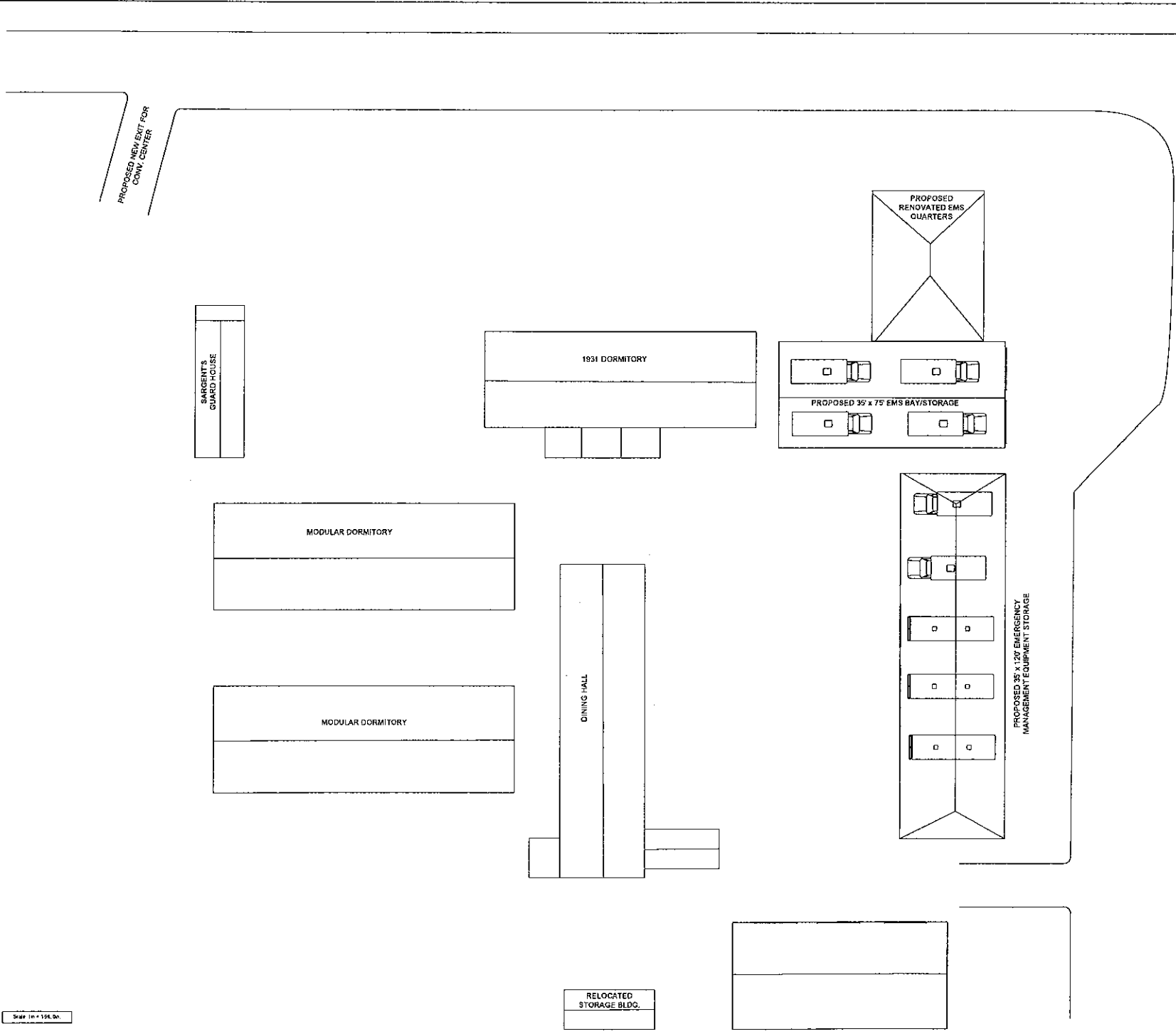

Scale 1/8" = 150.00'

HAYWOOD COUNTY
FACILITIES AND MAINTENANCE DEPARTMENT

**HAYWOOD COUNTY
FORMER NCDOT FACILITY**

12-23-2013
DB

**SITE PLAN
CS1.4
WAYNESVILLE
EMS/EM/MAINT.**

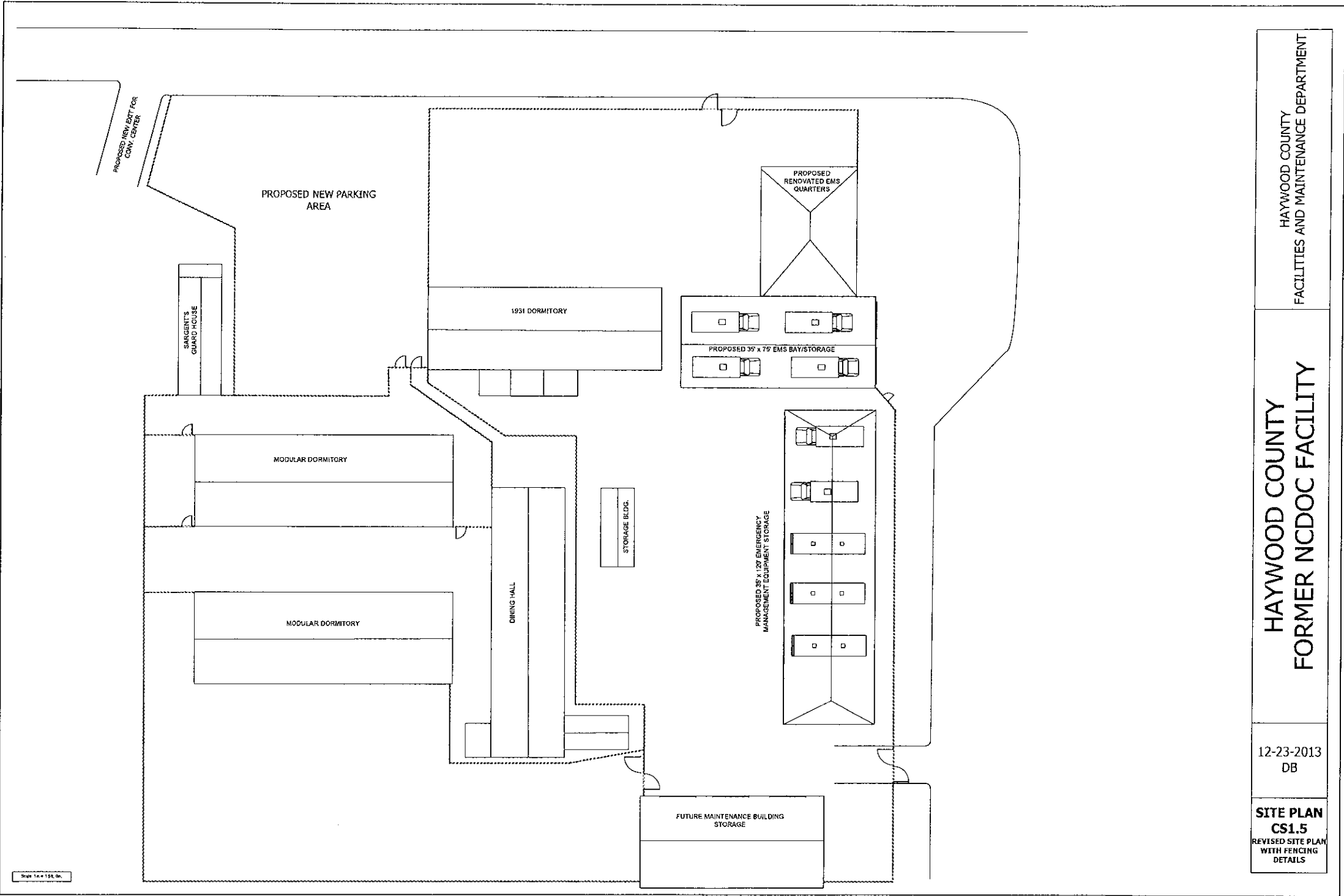

Scale 1/4" = 120' 0"

HAYWOOD COUNTY
FACILITIES AND MAINTENANCE DEPARTMENT

**HAYWOOD COUNTY
FORMER NCDOC FACILITY**

12-23-2013
DB

**SITE PLAN
CS1.5
REVISED SITE PLAN
WITH FENCING
DETAILS**

Attachment

2



Haywood Christian
Emergency Shelter

How it all began:

- November 2008 Patsy Dowling calls community meeting of government officials, churches and community non-profit organizations.
- The purpose of the meeting was to identify where in our community people could find assistance with food, heat and shelter.
- The churches at the meeting were asked to meet and see if they could discover a solution for the need for emergency shelter. Two weeks later, a dozen churches started Haywood Counties first ever shelter.

Our present model:

- We are an emergency shelter that opens on November 1st and closes April 30th
- Volunteers pick up guests from the Open Door in Waynesville and from the Community Kitchen in Canton after being fed each evening.
- A paid, trained and licensed security officer stays up all night to provide security. We also have a security camera system.
- In the morning, all guests are assigned chores that help keep the facilities clean and orderly.
- Throughout the year, we partner with Department of Social Services and Mountain Projects to come and do an assessment of each guest.
- To ensure the safety of the guests, volunteers and security each guest must submit to a Breathalyzer and drug test upon entering the shelter.

Vital Statistics:

- Over the past 5 years, we have helped many people.
- In 2008, we served 85 unique individuals. Of those, 40 finished the season no longer homeless.
- In 2009, we served 90 unique individuals. Of those, 43 finished the season no longer homeless.
- In 2010, we served 85 unique individuals. Of those, 42 finished the season no longer homeless.
- In 2011, we served 80 unique individuals. Of those, 39 finished the season no longer homeless.

- In 2012, we served 72 unique individuals. Of those, 37 finished the season no longer homeless.
- In the first two months of the 2013 season, we have served 30 unique individuals. Of those, 10 are no longer homeless.
- To date, our accumulative guests list includes 442 unique individuals. Of those, 210 are no longer homeless.
- Our youngest guest has been 3 month's old with our oldest being 87 years old.

Current Budget:

○ Last year's income was \$41,438.59.

A. The bulk of our income comes from contributions from local churches.

B. The other two streams of income are fundraisers and donations from individuals.

- Last year's expenses were \$39,030.92
 - A. 52% of which goes to pay for security
 - B. 27% of which pays our part-time director
 - C. 12% of which is utilities for Camp New Life
 - D. 14% is supplies (such as drug tests) and administrative costs
 - E. 5% of which is insurance

Moving Forward:

- We believe we can make a much greater impact by going to a permanent shelter model.
- We need to move to a new facility.
- We are asking for a long-time lease on one of the open squad bays at the old prison.
- We are asking for a long-time lease on the other open squad bay at the old prison for Hands up (halfway house).
- With 79% of our budget being spent on security and our director, we could experience significant savings if we were to share these two functions with the halfway house.
- Many of our homeless guests experience the same needs and difficulties as those who would be in the halfway house.

Present Board Members:

- President, Nick Honerkamp, Pastor of New Covenant Church
- Vice President, Jimmy Huey, Pastor of Lake Junaluska First Baptist Church
- Secretary, Alice Ensley, Open Door
- Patsy Dowling, Director of Mountain Projects
- Perry Hines, Director of the Open Door
- Beverly Brock, Director of Community Kitchen

- Wilson Strickhausen, Waynesville First Methodist Church
- Matthew Carver, Pastor of His Church
- Director, Russ McLamb

Present partners:

- Open Door
- Community Kitchen
- Mountain Projects
- Department of Social Services
- Haywood Baptist Association
- Haywood Community College – Career Connections

- Meridian Behavioral Services
- Haywood Christian Ministries
- Circles of Hope
- Hands up (Halfway House)
- Haywood County Sheriff Department
- Waynesville Police Department
- A.B.C.C.M.'s Veterans Rapid Re-housing

Attachment

3



Next Step Ministry

A LOCAL 501c3, NON-PROFIT ORGANIZATION



MISSION STATEMENT

- Next Step Ministry is a Christ-centered HUB for those seeking help who are challenged by life's circumstances; whether by incarceration, substance abuse, or poor life choices. Our mission is to provide a network that will inspire regeneration through breakthroughs and offer life skills that will achieve immediate and lasting transformation.



VISION-SHORT TERM GOAL

- To provide Half-way Houses in Haywood County lodging both men and women.

BENEFITS OF A HALF-WAY HOUSE

- Meets an ongoing and unmet need in Haywood County.
- Produces self-motivating and self-sustaining members of society.
- Produces future taxpayers for our local communities and county.
- Reduces local jail recidivism rate; saving taxpayers an estimated \$30 a day per inmate.
- Complements available resources in community, rather than compete with them.
- Reduces need for foster parenting, saving NC tax dollars.



PRIMARY TARGET OF THE HALF-WAY HOUSE

- Ex-offenders – both men and women.

WHY EX-OFFENDERS?

- For every person incarcerated, there are at least 3 to 5 other individuals directly affected- spouses or mates, children, parents / grandparents, siblings...etc. Thus placing a strain on federal, state, and local assistance programs or agencies.
- Reduces future risk of children following in steps of incarcerated parents. The current stats reveal there is an 85% chance children with incarcerated parents will at some point be incarcerated.
- In 2013, the recidivism rate for Haywood County Detention Center was.
- Fact: Un-regenerated Ex-offenders do become our neighbors; whether we like it or not.



OTHER PARTICIPANTS INCLUDE:

- Substance Abusers or those suffering from addictive behaviors.
- High School drop-outs.

PROGRAM INSIGHT

- Application into the program is voluntary.
- An assessment form is completed by potential participants before entering the program.
- The assessment form determines the recommended amount of time spent in the program to achieve the clients short term goals.
- The estimated cost per house resident is \$30 per day.



PROGRAM BENEFITS

- Participants invest personally through the maintenance of the home as well as other daily responsibilities.
- Provides structure through a set daily routine.
- Generates personal pride and self-esteem.
- Promotes healthy boundaries for relationships and life choices.
- Various degrees of support to be given: Computer classes, acquiring GED, discipleship and life skill classes.



PROPOSED SITE FOR HALF-WAY HOUSE

- The old Department of Corrections property, adjacent to Haywood County Detention Center.
- Close proximity to Detention Center allows a released inmate immediate access to the Half-way house program or access to the available network of resources that best fits their most pressing and current need.



ESTIMATED COST OF PROJECT

- To bring the property up to local building code –approximately \$40k per building.
- Next Step Ministry requires 2 buildings; one for men residents and one for women residents.



PROJECT FUNDING

- Next Step Ministry will incur cost of building renovations – estimated at \$80k.

PROPOSED LEASE

- Next Step Ministry is proposing a 10 year lease on the facility requesting a 6 month notification before end of lease as a reminder of lease renewal.
- Formal lease to be reviewed by an attorney.